

# Trilogy® T2 DL2700:

## #1 standalone electronic keyless access lock

New On-Trend Matte Black  
US19 Finish  
Also Available!

Durable BHMA Grade 1 digital locks available in indoor and outdoor models.



- **Grade 1 Durability.** Dependable lockset with rugged clutch mechanism, plus **vandal-proof all metal keypad.**
- **Multi-level user codes:** Master, 10 managers, 90 users, 3 service codes
- **Up to 100 different user codes** (3-6 digits)
- **100% keypad programmable** with a fingertip
- **Individual, group or total user lockout codes**
- **Easy passage mode** by manager and/or master
- **Easy to install in about an hour,** retrofits cylindrical knobsets and digital locks using slightly modified ANSI 161 Series Prep
- **Standalone battery operated;** 5 AA batteries rated at 200,000 cycles
- **Non-handed** for easy installation and versatility
- **2-wire remote override**
- **Visual and audible entry indicators**
- **WP Models for weatherproof performance,** water-sealed for use inside and out, with operational temperature range of +151°F to -31°F (+66°C to -35°C)

*(Note: all Trilogy models are available in WP weatherproof and non-WP standard models for interior doors.)*



 **ALARM LOCK**

Ideal for schools, healthcare, pharmacies, rental properties, offices, retail and airports.

**OPERATION:** Clutch mechanism permits turning lever without retracting latch and reduces stress on lock bodies and spindle. Outside lever free turning in locked position. Entering access code, key bypass, or remote bypass will allow lever to retract latch. Inside lever always instant egress

**DOOR THICKNESS:** 1 5/8" to 1 7/8." Other thicknesses. Please consult Alarm Lock

**BACKSET:** 2 3/4" Standard. 2 3/8" backset also available

**KEYPAD:** All metal, 12 button programmable for multi-level access functions including group or individual user codes, master and management codes, passage and emergency or service code, lockout and remote override capability and allowable entry time from 5 to 20 seconds. 4 Different keypad tones and keypad may be silenced

**STANDARD KEY OVERRIDE CYLINDERS:** Solid brass 6 pin tumbler cylinder pinned 5, SC1 keyway, furnished in all locks. Additional tailpieces included: HW580 fits Schlage, Corbin/Russwin CL, Sargent 480 Series, ASSA65-611. Model HW620 fits Ilco and Lori cylinders

**INTERCHANGEABLE CORE MODELS:** Accepts 6 & 7 Pin Cylinders from: Best, Arrow, KSP, Medeco Keymark & Kaba Peaks. Also available IC Core models for Yale, Medeco, Sargent, Corbin/Russwin CL and Schlage. Alarm Lock Tailpiece is supplied; IC Core is not included

**LATCHBOLT:** UL Listed, fire rated, 3 hours, 1/2" throw, solid brass, deadlocking. Reversible. Adjustable front for flat or beveled doors

**STRIKE:** 1 1/8" x 2 3/4" T strike & 1 1/4" x 4 7/8" ASA strike included. With screws for wood or metal jambs

**LATCH FRONT:** 1 1/8" x 2 1/4" wrought brass or stainless steel

**HANDING:** Non-handed

**FINISHES:** US19 Matte Black, US26D Satin Chrome, 10B Duronodic

**POWER:** 5 AA alkaline batteries are now rated at 200,000 cycles, supplied. Audible low battery alert, visual and audible entry indicators, unique Flex Drive® motor

**DOOR PREP:** Standard ANSI 161 Series Prep, modified by adding additional through-bolt holes

**COMPLIANCES:** Grade 1, heavy duty cylindrical lockset, UL listed and FCC certified. ADA compliant leversets

**Trilogy is available in many additional models, including those for outdoors, &/or Mortise, exit trim panic devices, plus with Prox ID card reader, dual-sided keypads, wireless lock networks and more.**

**Some other Trilogy Options:**

DL2700LD With LocDown™ Indicator Light Bar & Keyfob

DL2700CR T2 Mortise, Classroom version

DL2700DB T2 Mortise, Deadbolt version

DL1200 Models for Narrow Stile Glass Doors

DL1200ET T2 Narrow Stile Exit Trim for use with Panic Devices (generic rim cyl. supplied)

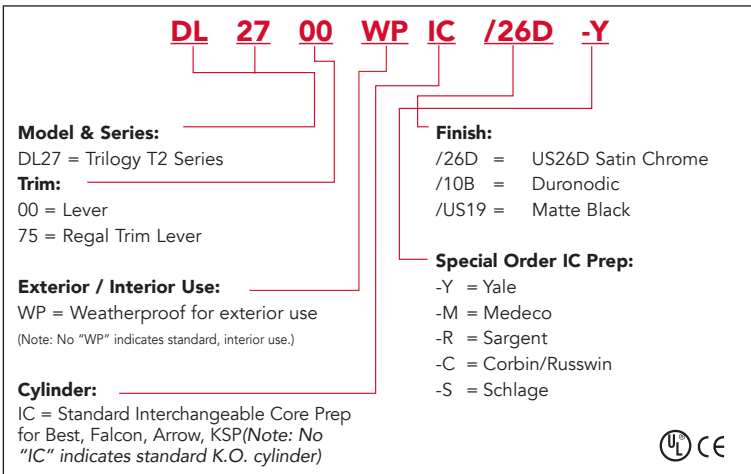
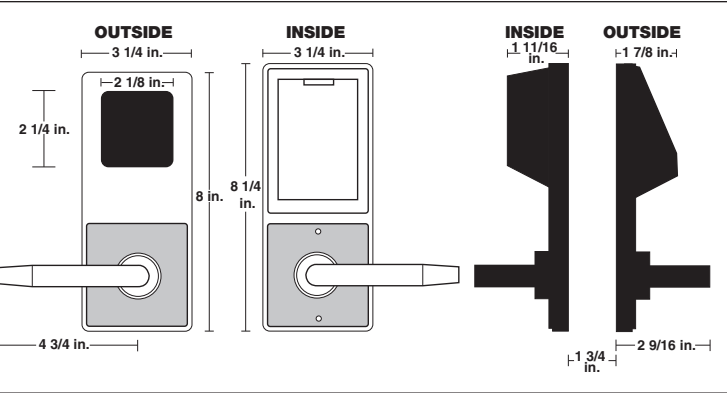

**NEW!**  
DL2700/19  
Matte Black



With IC Core in 26D  
DL2700IC/26D



Secure battery  
compartment on  
inside door



DL2775/26D

ETDL27 T2 Exit Trim for use with Panic Devices (generic rim cyl. supplied)

DL5200 Dual-Sided PIN Lock

RR-TRILOGYKIT Optional Remote Release Kit

See Trilogy Networkx™ Locks for wireless network capabilities



**Alarm Lock Systems, LLC** (A Division of NAPCO Security Technologies, Inc.)

333 Bayview Ave, Amityville, New York 11701

1-800-ALA-LOCK • www.alarmlock.com • salesinfo@alarmlock.com